

Cam action indexing plungers

with flange for surface mounting,
Guide zinc die casting

SPECIFICATION

- Guide
 - Zinc die casting
 - plastic coated
 - black, RAL 9005, textured finish **SW**
- Pin
 - Steel
 - zinc plated, blue passivated
- Lever
 - Plastic (Polyamide PA)
 - black, matt
 - not removable



INFORMATION

Cam action indexing plungers GN 612.10 are used in cases where the plunger must not protrude all the time. By rotating the lever through 180° the plunger withdraws itself. The groove allows safe positioning.

- Range of cam action indexing plungers (see page 816)

TECHNICAL INFORMATION

- Plastic characteristics (see page A2)

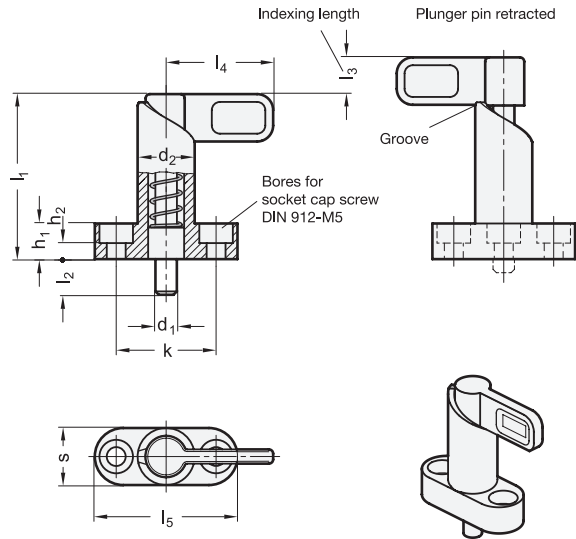

GN 612.10

Description	d1 Pin-0.05 Bore +0.1/+0.05	l2	d2	h1	h2	k	l1 ≈	l3	l4	l5	s	Spring load in N ≈ initial	Spring load in N ≈ end	
GN 612.10-6-10-16-SW	6	10	16	10	4.5	28	46	10	30	40	16	12	32	53
GN 612.10-6-16-16-SW	6	16	16	10	4.5	28	46	10	30	40	16	12	32	67
GN 612.10-8-10-16-SW	8	10	16	10	4.5	28	46	10	30	40	16	12	32	68
GN 612.10-8-16-16-SW	8	16	16	10	4.5	28	46	10	30	40	16	12	32	50
GN 612.10-8-12-20-SW	8	12	20	10	4.5	32	57	12	37	45	20	21	58	20
GN 612.10-8-18-20-SW	8	18	20	10	4.5	32	57	12	37	45	20	21	58	120
GN 612.10-10-10-16-SW	10	10	16	10	4.5	28	46	10	30	40	16	12	32	70
GN 612.10-10-16-16-SW	10	16	16	10	4.5	28	46	10	30	40	16	12	32	74
GN 612.10-10-12-20-SW	10	12	20	10	4.5	32	57	12	37	45	20	21	58	126
GN 612.10-10-18-20-SW	10	18	20	10	4.5	32	57	12	37	45	20	21	58	130
GN 612.10-12-12-20-SW	12	12	20	10	4.5	32	57	12	37	45	20	21	58	130
GN 612.10-12-18-20-SW	12	18	20	10	4.5	32	57	12	37	45	20	21	58	135